

送り機構、針受  
Feed Mechanism and Needle Guard

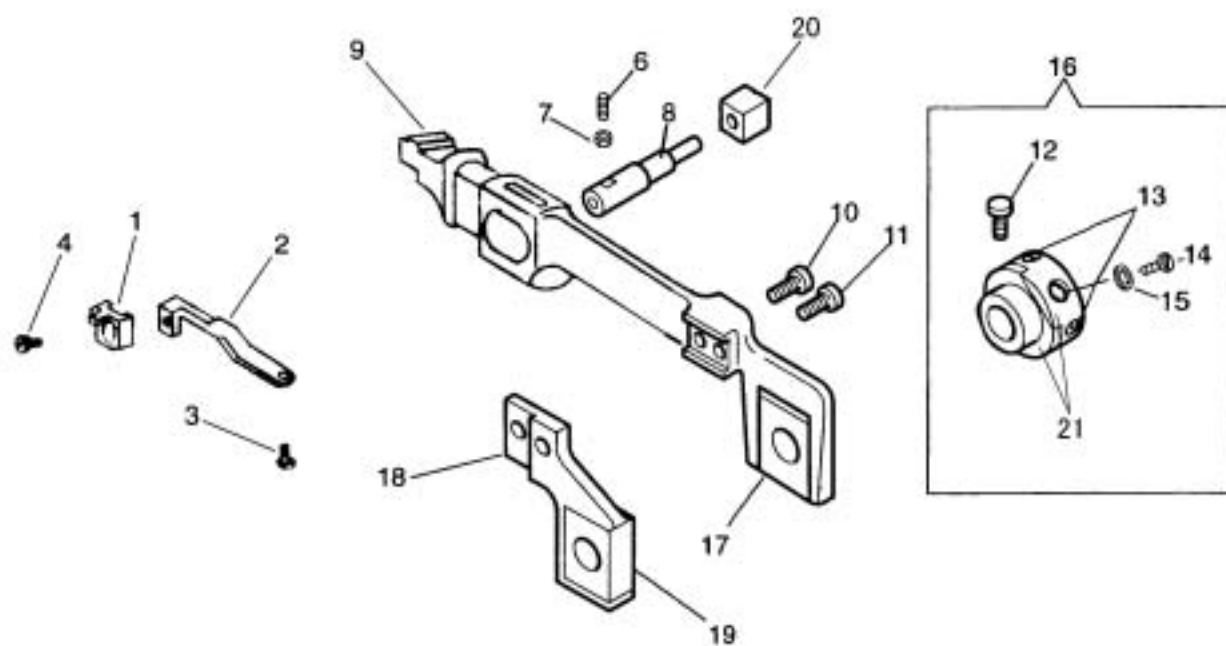

# 送り機構、針受

## Feed Mechanism and Needle Guard

NO.	部品番号 PART NO.	L26	T26	個数 QTY	品名	DESCRIPTION
1	132381	*	*	1	針受	Needle Guard
2	132382	*	*	1	針案内台	Needle Guard Holder
3	100193	*	*	1	針案内台止ねじ	Screw 9/64X40 L=6.4
4	100223	*	*	1	針受止ねじ	Screw 1/8X44 L=5
6	100443	*	*	1	送り腕偏芯ピン止ねじ	Set Screw 15/64X28 L=9.97
7	101520	*	*	1	送り腕偏芯ピン止ねじナット	Nut
8	134737	*	*	1	送り腕偏芯ピン	Feed Bar Hinge Pin (eccentric)
9	143448	*	*	1	送り腕	Feed Bar
10	100914	*	*	1	送り上下二又止ねじ(短)	Screw 11/64X40 L=8.7
11	100172	*	*	1	送り上下二又止ねじ(長)	Screw 11/64X40 L=9.9
12	150328	*	*	1	送りカム調節ねじ	Feed Regulating Screw 7/32X32
13	151061	*	*	2	送りカム台止めねじ	Set Screw 15/64X28 L=8.5
14	100217	*	*	1	送りカム決めねじ	Screw 9/64X40 L=4.8
15	107071	*	*	1	ワッシャー	Washer
16	416071	*	*	1	送りカム 送り土台(組)(ねじ、ワッシャー付)	Feed Eccentric (adjustable) Assembly
17	143450	*	*	1	送り角駒	Slide Block
18	139432	*	*	1	送り上下二又	Feed Lifting Eccentric Forked Connection
19	143451	*	*	1	送り上下角駒	Slide Block
20	139046	*	*	1	偏芯ピン角玉	Slide Block
21	122163C	*	*	1	送りカム 送り土台(組)	Feed Driving Flange Assembly