

# SK-2B-20-1

Single needle, Extra heavy duty, 20 inch long arm,  
Extra Large horizontal axis hook, Upper and lower feed,  
Reverse stitch, Lockstitch machine



**SK-2B-20-1**

## Variety

### **SK-2B-20-1**

Standard model

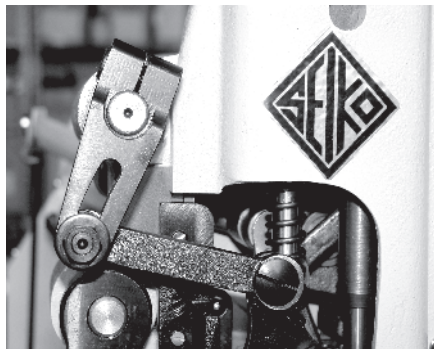

Alternating presser foot lift relative parts

## Applications

- For sewing heavy weight leather, canvas, vinyl, and various coated and laminated fabrics
- Suitable for sewing such products as harnesses, covers, safety belts, tents, sheets, gloves, buffs, and heavy duty travel bags.

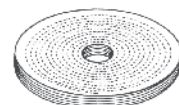
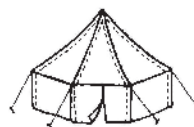

## Features

- Horizontal axis rotary hook with extra large capacity bobbin minimizes the time to replace the bobbin thread.
- SK series is the powerful sewing machine in the SEIKO specially designed for ultra heavy duty materials.

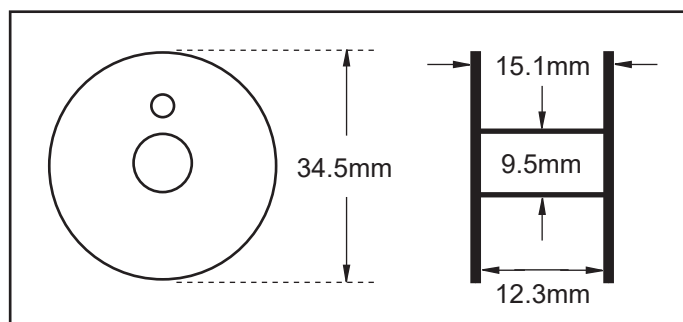

Large bobbin

## Specifications

Variety	SK-2B-20-1	
Number of needle	Single needle	
Max. sewing speed	900 s.p.m.	
Max. stitch length	1/2" (13 mm)	
Clearance under presser foot	by pedal	35/64" (14 mm)
	by hand	1/2" (13 mm)
Needle bar stroke	2" (50.8 mm)	
Needle(standard)	DDx1 (#24) , 328 (#180)	
Thread	#0 - #5 (standard #5)	
Hook	Extra Large horizontal axis hook	
Amount of lift of presser foot	1/8"-15/64" (3 - 6 mm) , standard 5/32" (standard 4mm)	
Thread take up lever	Link type	
Lubrication	Hand type	
Bed size	30-35/64" x 9-61/64" (776 x 253 mm)	
Bobbin size	Φ 1-29364" (Φ 34.6 mm), t=19/32"(15mm)	
Working space	20-5/64"x 7-31/64" (510 x 190 mm)	
Net weight(Head only)	71 Kg	

NOTE: (1) Speed depends on threads, materials and type of operation

(2) Specifications subject to change without notice



### SEIKO SEWING MACHINE CO., LTD.

2-13-6, Sakaecho, Funabashi-shi  
 Chiba Prefecture, 273-0018, Japan  
 Phone : +81-47-420-3561 (Overseas dept.)  
 Fax : +81-47-420-3560  
 E-mail : exsales@seiko-sewing.co.jp

Printed in Japan 2024. 7

<https://www.seiko-sewing.co.jp/en/>